

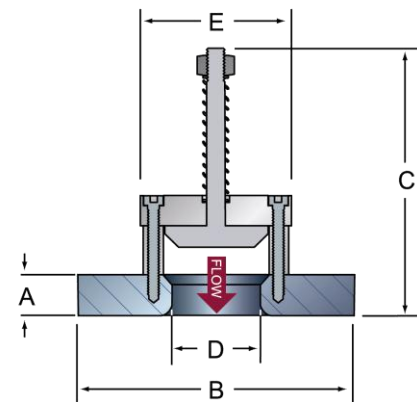

## **EXCESS FLOW VALVE – 2000 SERIES** **- 2105**

2105 Series Excess Flow Valves are designed to easily insert between ANSI class flanges for use in liquid or vapor service. These valves are lightweight, durable and offer a more generous flow rate than the 2100 model. Standard design on the 2105 Series valve has a weep hole to allow for pressure equalization once the valve closes. An optional external manual bypass system is also offered (shown in photograph below.) This reduces the time it takes for pressure to equalize and the valve to reopen. The valve is available in carbon or stainless steel - other materials available upon request.

Model	Size	A Width	B Dia.	C Length	CV Ranges
2105-G	1.5"	1/2	2 7/8	2 5/8	9 - 22
2105-I	2"	1/2	3 5/8	3 11/32	22 - 28
2105-K	3"	1/2	5	3 23/32	45 - 57
2105-L	4"	5/8	6 3/16	4 11/16	81 - 101
2105-M	6"	3/4	8 1/2	7 7/32	181 - 227
2105-N	8"	3/4	10 5/8	8 3/16	343 - 450
2105-P	10"	7/8	12 3/4	11 5/16	600 - 750
2105-Q	12"	1.25	15	14 1/2	950 - 1188
2105-R	14"	1.50	16 1/4	16 1/2	1225-1800

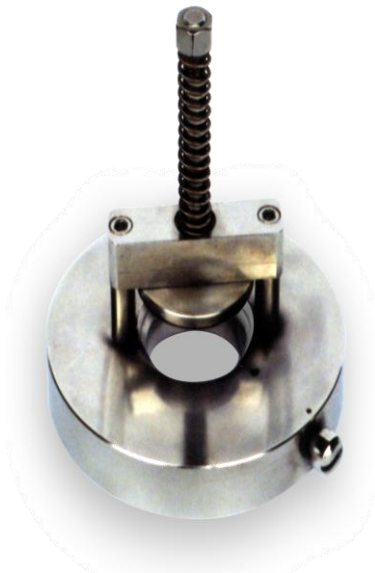

Typical dimensions are listed. Data contained herein can be altered to accommodate design changes and changes to increase performance. Information on this page is the sole property of L6 Inc. d/b/a Total Valve Systems.